

<b>Base Price:</b>	<b>\$170,272.00</b>
6/12 Roof Slope	3,038.00
9' Ceilings	3,438.00
Premium Color Vinyl Siding	850.00
Window and Door Lineals	1,256.00
2 Medium Gables	2,912.00
Extra Roof Detail	215.00
1' Small Bump-Out Window (Bath #2)	520.00
1' Large Bump-out BR	859.00
Upgrade Carpet	1,652.00
Vaulted Ceilings (LR, DR, Kitchen)	1,655.00
Upgrade 3 Panel Oak Doors (x16)	4,080.00
Premium Trim Package	5,518.00
Interior French Doors With Glass	1,550.00
Laundry Area w/Saybrooke Birch Cabinets	1,086.00
6' of Saybrooke Cabinets with SS Laundry Sink	1,669.00
Wire for Electric Range	175.00
Paddle Fan Light (BR #1)	178.00
10 LED "Recessed-Look" Lights	650.00
Brushed Nickel Bath Package	935.00
Extra 3/4 Bath	2,450.00
Kohler Hi-rise Toilets	430.00
Stand Alone Tub/Faucet	3,886.00
Double Sink Vanity	725.00
Double Drawer Bases Bath #2	264.00
Cultured Granite Vanity Tops	699.00
Vanity Base Drawers (Bath #1)	226.00
Recessed Medicine Cabinet (Bath #1)	65.00
Nutone 3-door Medicine Cabinets (disc.)	426.00
Quartz Kitchen Countertops	8,974.00
Saybrooke Birch Cabinets (disc.)	3,430.00
Select Cabinet Option (Kit. only)	680.00
8.5' Extra Base Cabinets	1,828.00
6' Extra Wall Cabinets	1,008.00
Kitchen Draw er Base	297.00
Ceramic Tile Backsplash (NA)	595.00
Crown Molding Above Kit Cabinets (31')	620.00
15" Deep Wall Cab. w/Glass Doors	462.00
Custom Cabinets	431.00
Country Apron Sink	825.00
Kit. Faucet (K22033VS)	410.00
Frosted Pantry Door	869.00
Whirlpool Dishwasher	674.00
Whirlpool Microwave (w/Vented to Exterior Option)	594.00
Suntube (x3)	2,385.00
Pella 250 Dbl-hung Windows	4,738.00
3' Transom Windows (x2)	936.00
2 Deadbolts	138.00
Front Door, Sidelight & Transom (S684HRR, S694HRR, TR90 Clear Transom)	3,546.00

**"Home Only" w/Options Shown: \$245,119.00**

Prices are Subject to Change

*Design Homes, Inc.*



**Chippewa Falls, WI**  
(#11017 -0-6)

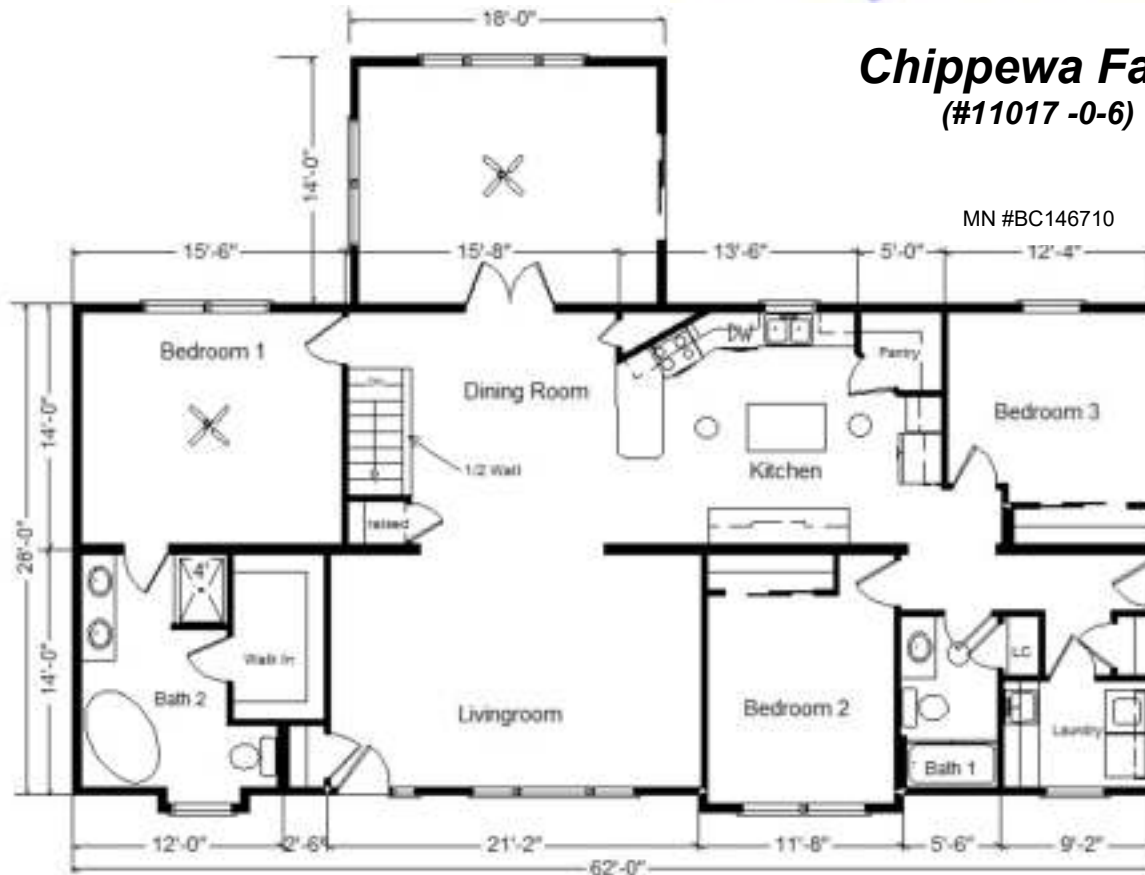

**Price Includes: Crane Setting, All Blueprints, R55 Ceilings, R21 Exterior Walls, Kohler Plumbing, Pella Windows, 200 Amp Service, All Applicable Tax and Much More!!**

**\*\*See Sales Rep For Applicable Delivery Fees**

**Color Information**

*Spruce Siding, Forest in Gables, White Trim, Driftwood Shingles, White Lineals, White Baths, #688 Vanity Tops, Townhouse and Dunes Carpets, Sand Dune and Outerbanks Mohawk Revwood, Saddle Trim & Doors, Umber Cabinetry Black Appliances, Pella 250 White Dbl-hung Windows, Rolling Stone Quartz Kit. Countertop, Brushed Nickel Package*

Feb. 2024

<b>14 x18 SR w/Gable Base Price</b>	<b>\$29,214.00</b>
Vaulted Ceiling	542.00
Premium Color Vinyl Siding	168.00
Window and Door Lineals	680.00
Premium Trim	801.00
Paddle Fan/Light	178.00
Revwood Flooring	1,081.00
Pella 250 Dbl-hung Windows	3,137.00
6' Pella 250 Patio Door	2,812.00
<b>"Sunroom Only" Sub-Total</b>	<b>38,613.00</b>
<b>Total With Options Shown:</b>	<b>\$283,732.00</b>

**Model #6**  
**28x62 Ranch**  
**w/Optional 14 x 18 Sunroom**  
**2,002 sq. ft.**