

# 28 x 36 RANCH

1,008 Sq. Ft.

PROD# : 8812L - 6 1

BASE PRICE..... \$62,818.00

**OPTIONS:**

Utility Hook Ups w/Cabinets..... \$695.00

Laminate Flooring(Foyer, Kitchen)... \$533.00

Upgrade Carpet(Gorham)..... \$575.00

Kolbe Vinyl Double Hung Windows.. \$500.00

5' Roof Rise(3.91/12 Slope)..... \$900.00

TV/Phone Jack..... \$13.00

Sub-total..... **\$66,034.00**

Less Discount..... **\$2,500.00**

Total..... **\$63,534.00**

- 1] STUD WALL= 2X6X8 CATH CEILING= NONE SPACING= 24" O.C.
- 2] ROOF RISE= 5' [APPROX PITCH= 3.91 IN 12] SHINGLES= LANDMARK WEATHERED WOOD GABLE= NONE
- 3] SIDING= GRANITE GREY SHUTTERS= BLACK FACIA/SOFFIT= WHITE
- 4] WINDOWS= KOLBE VINYL DBL-HUNG WHITE
- 5] CABINETS= CHADWOOD COUNTER TOP= 4170-60 BEIGE PAMPAS
- 6] RANGE HOOD= WHITE UNVENTED
- 7] KITCHEN SINK= STAINLESS STEEL WIRE FOR ELECT RANGE= NO
- 8] BATH= WHITE TOP= #85 WHITE ON WHITE BASE= CHADWOOD
- 9] SHOWER ENCLOSURE= ROD
- 10] HEAT=
- 11] WATER HEATER=
- 12] ELECT POWER=200 AMP
- 13] APPLIANCES= WIRE FOR FUTURE DW
- 14] GYPSUM BOARD SPRAY TEXTURE= ORANGE PEEL WALLS & POPCOORN CEILINGS
- 15] STANDARD DOORS & TRIM
- 16] USE MIRROR W/LIGHT BAR & RECESSED MED CABINET IN BATHROOM
- 17] LABELS & DATA PLATES INSTALLED UNDER KITCHEN SINK
- 18] COUNTERS OVER 12' WILL BE SPLICED
- 19] PLUMBING #20060092, 020060135, 20060083

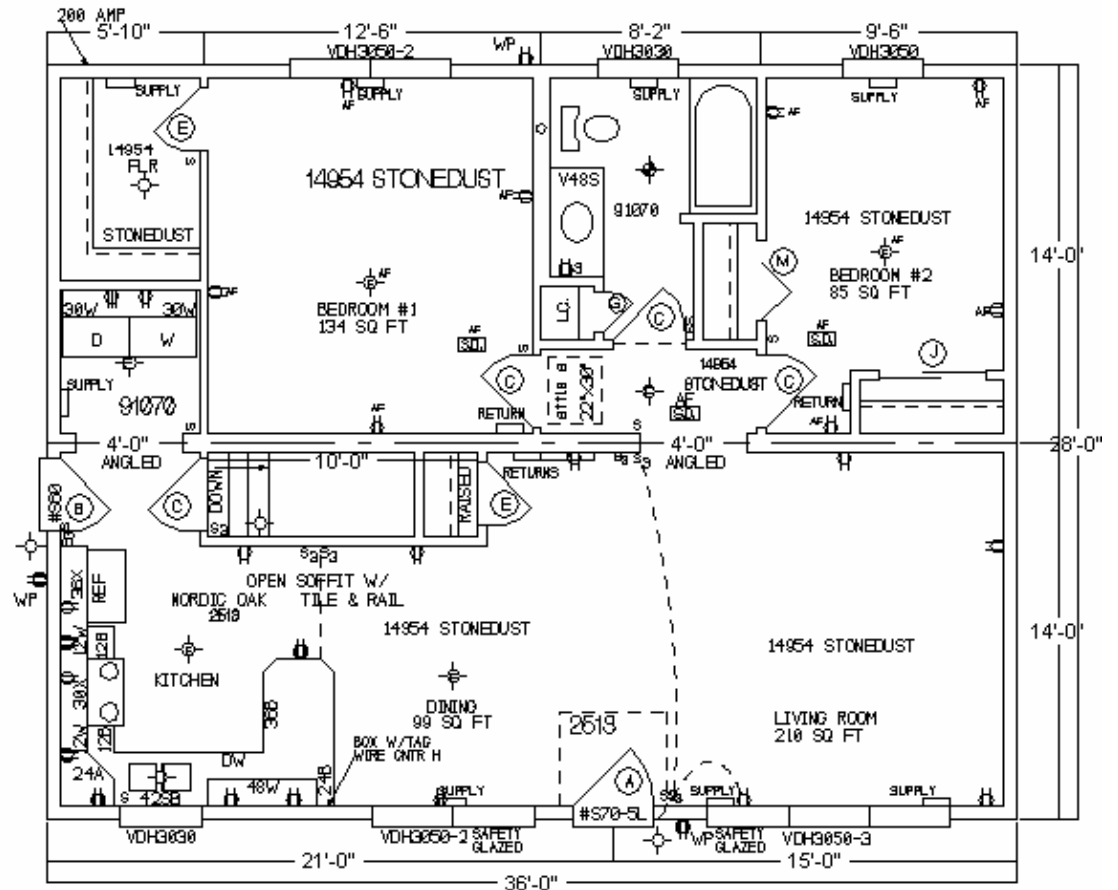

20] PER MINNESOTA ENERGY CODE, THIS DWELLING MAY REQUIRE AN AIR TO AIR HEAT EXCHANGER, DESIGNED, SUPPLIED, AND INSTALLED ON-SITE BY OTHERS