

# Model #7

28x62 Ranch w\SR 1988 sq. ft.

# Design Homes, Inc.

Sioux Falls, SD

(#1486 -5-5)



**Base Price: \$94,314.00**

**This Home Displays The Following Options:**

* 7' 6" Roof Rise (approx. 6/12 slope)	2,728.00
* Kolbe Dbl-hung Windows	500.00
Hip Roof (Both Ends)	3,618.00
Large Gable	1,074.00
Extra Gable Detail	193.00
1' Bump-Out Of Small Window (Bath #2)	464.00
Upgrade Carpet (WL)	1,144.00
Tile-look Laminate (Din, Utility, Foyer)	1,625.00
Vaulted Ceilings (LR, DR, Kitchen)	1,261.00
Gas Fireplace	3,159.00
Oak Trim & Doors	1,150.00
Upgrade 6 Panel Oak Doors (x10)	1,950.00
Interior French Doors w/Glass	534.00
Box w/Pull Tag Wire	13.00
Paddle Fan/Light (LR)	164.00
Extra 3/4 Bath	1,839.00
Utility Hook-Up w/Cabinets	695.00
Capella Corner Whirlpool	2,400.00
Double Sink Vanity	565.00
Vanity Base Drawers (x3)	264.00
Shower Door (Bath #2)	160.00
Seneca Ridge Oak Cabinets	2,137.00
8' Extra Base Cabinets	1,040.00
5.75' Extra Wall Cabinets	610.00
Crown Molding Above Kit Cabinets (30')	201.00
5' Mullion Glass Door Wall Cabinets	325.00
* GE Dishwasher	421.00
Suntube (x2)	1,060.00
* Extra Kolbe Windows (Bdr. 2 & 3)	718.00
Upgrade Front Door (SS684HRRB)	1,117.00
Sidelight 1/2 Glass (SS692HRRB)	1,204.00
* Kolbe 6' Patio Door (Bdr. #1)	1,001.00

**Home Total w/Options \$129,648.00**

**14 x18 SR w/Gable Base Price \$16,331.00**

Vaulted Ceiling	428.00
Upgrade Carpet (WL)	291.00
* Kolbe 6' Patio Door	1,001.00
Paddle Fan/Light	126.00
Credit 32" Door	-240.00

**Sunroom Total \$17,937.00**

**Total With Options Shown: \$147,585.00**

**Buy Display Model For:  
\$132,827.00!  
(discounted 14,758.00!)**

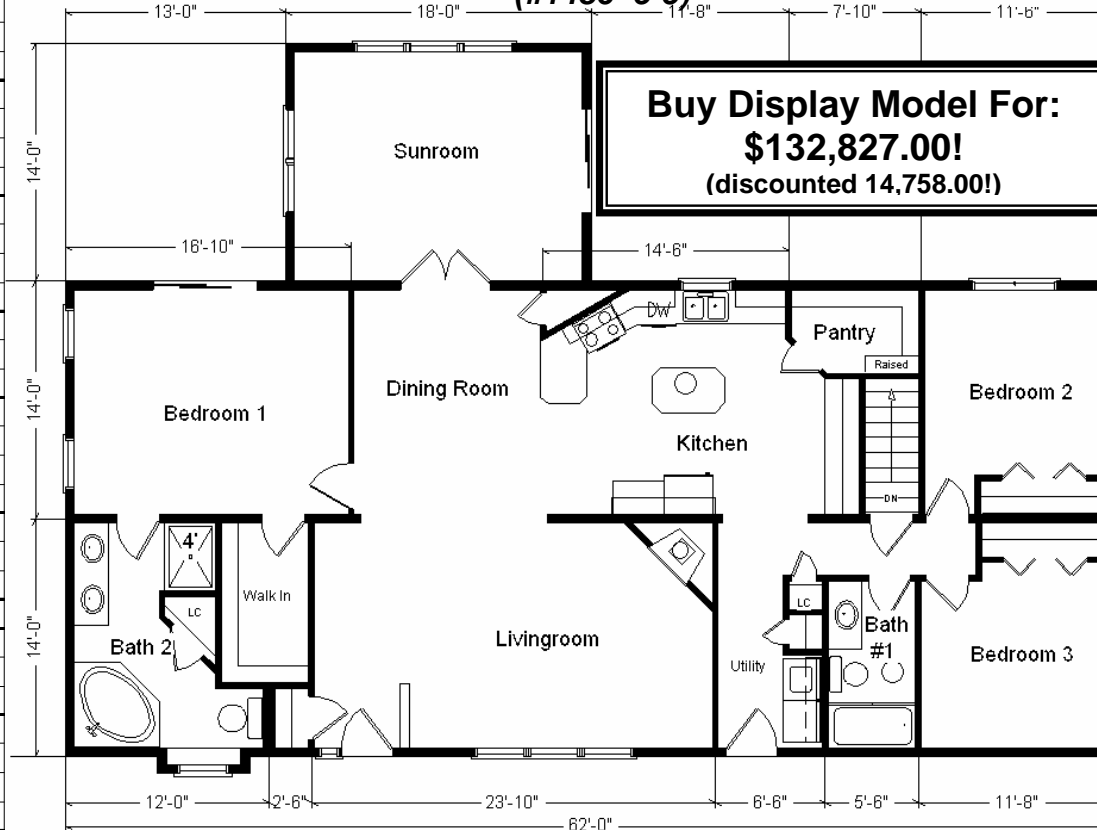

**28x60 Variation...**

Feb. 2009

### Color Information

Gr. Gray Siding, White Trim, Black Shingles, Black Shutters, White Baths, Toast Carpet, 91057 Vinyls, 137734 Laminates, Bisque Sink, Nutmeg Oak Trim & Doors, Bisque DW & Rangehood, White Kolbe Dbl-hung Vinyl Windows, Sage Coral Countertop

**Price Includes All Blueprints, Delivery, Crane Work, Water Heater, Finish Ready For Hookups, Lennox Furnace Installed, & Tax!**

### Optional Garage 24' x 24'

Base Price.....9,614.00  
6/12 Roof Slope .....1,056.00  
Gable Garage Roof... ..1,620.00  
**Total.....\$12,290.00**

28x60 Base Price:.....	\$ 92,064.00
<b>With the most Popular Options:</b>	
Whirlpool Dishwasher.....	439.00
Utility Hook-ups.....	395.00
6' Patio Doors.....	481.00
¾ Bath.....	1,839.00
Corner Soaker Tub.....	1,300.00
<b>Variation Total w/Options:..</b>	<b>\$96,518.00</b>