

Base Price:	\$135,148.00
This Home Displays The Following Options:	
6/12 Roof Slope	3,038.00
Large Gable	1,995.00
Extra Gable Detail	215.00
1' Bump-Out Window (Bath #2)	520.00
3.5" Window/Door Lineals	1,267.00
Vinyl Shake Siding on Bump-out	133.00
Upgrade Carpet (EDL II)	2,487.00
Tile Laminate (Kit, Din,)	2,413.00
Vaulted Ceilings (LR, DR, Kitchen)	1,595.00
Gas Fireplace	5,600.00
Upgrade 6 Panel Oak Doors (x10)	2,150.00
Interior French Doors w/Glass	1,185.00
Paddle Fan Light (x2)	367.00
Wire for Electric Range	100.00
Extra 3/4 Bath	2,450.00
Laundry Area w/Cabinets	750.00
Brushed Nickel Package	1,165.00
Corner Whirlpool	3,200.00
Double Sink Vanity	725.00
Recessed Medicine Cabinet (x2)	130.00
Vanity Base Drawers (x3)	396.00
Cultured Granite Vanity Tops	590.00
Seneca Ridge Oak Cabinets	2,400.00
8.5' Extra Base Cabinets	1,369.00
7.5' Extra Wall Cabinets	923.00
Ceramic Tile Backsplash	350.00
Crown Molding Above Kit Cabinets (31')	496.00
Pull-out Kit. Faucet (K15160-BN)	195.00
5' Mullion Glass Door Wall Cabinets	425.00
Whirlpool Dishwasher (DU850)	504.00
Whirlpool Microwave (WMH2175)	414.00
Suntube (x4)	2,240.00
Pella Lifestyle Windows	5,955.00
Upgrade Front Door (S684TRC)	516.00
Sidelight (Full Glass)	599.00
Home Total w/Options	\$184,005.00
14 x18 SR w/Gable Base Price	\$23,599.00
Vaulted Ceiling	542.00
Upgrade Carpet (EDL II)	644.00
Paddle Fan/Light	163.00
Pella Lifestyle Windows	2,943.00
Peachtree Patio Door (700PS2)	1,798.00
Sunroom Total	\$29,689.00
Total With Options Shown:	\$213,694.00

Design Homes, Inc.

Missouri Valley, IA
(#9929 -2-4)

Sept. 2020



MN #BC146710

Model #5
28x62 Ranch w/Optional Sunroom
1,988 sq. ft.

Color Information
Sterling Gray Sidings, White Trim, White Corner Posts, Driftwood Shingles, White Lineals, White Baths, #430 Vanity Tops, Parchment Carpet, DF9320 Vinyls, 775 Berkeley Laminate, SS Kit. Sink, Nutmeg Oak Trim & Doors, Black Dishwasher & Microwave, Pella White Dbl-hung Windows/Nutmeg Interiors, Mocha Travertine Countertop, Green FP Front

Buy Display Model For:
\$169,694.00!
(Discounted 44,000 !)

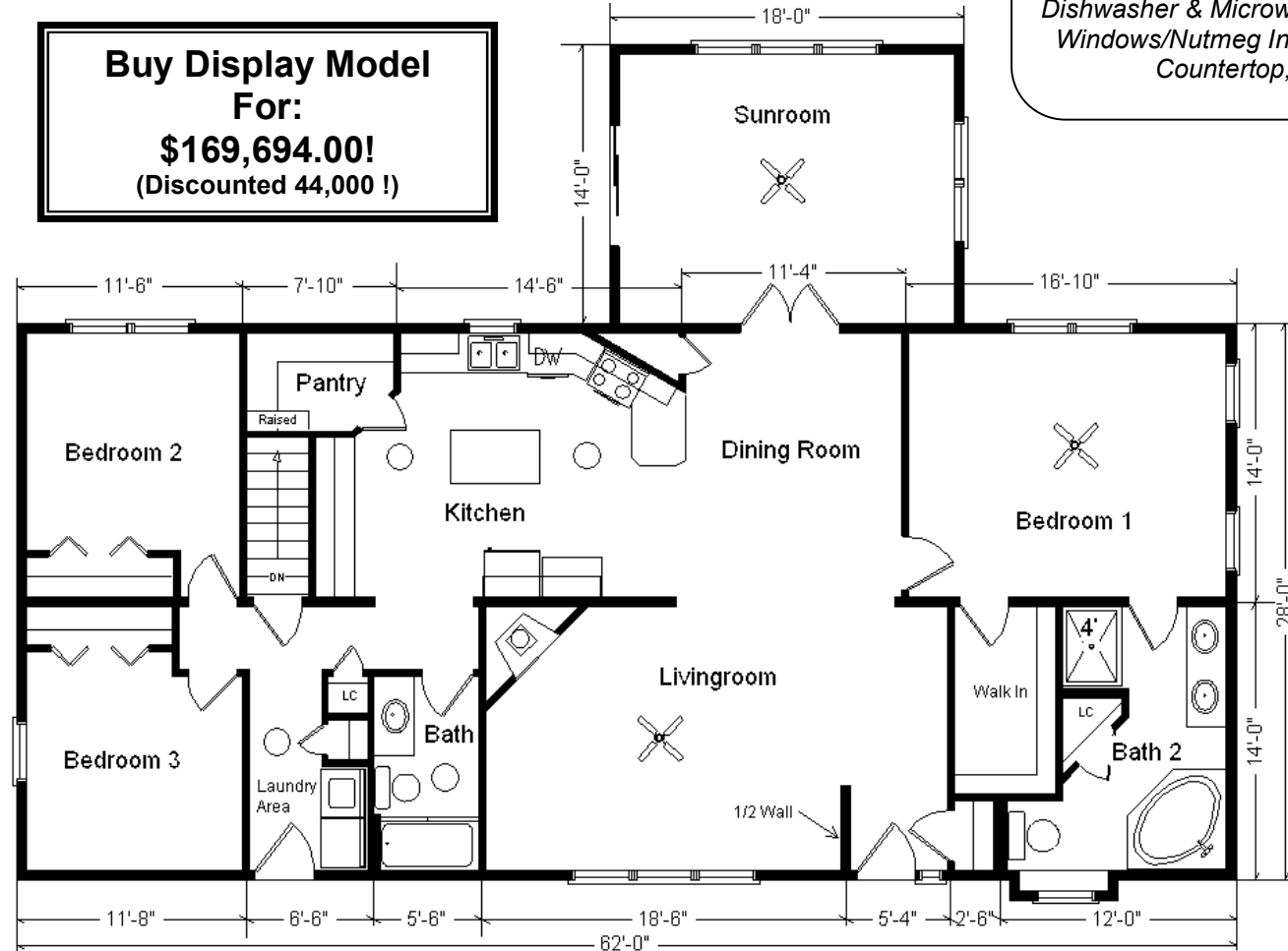

Price Includes: 100 Mile Delivery, Crane Work, All Blueprints, R55 Ceilings, R21 Exterior Walls, 2x10 Floor Joists, Kohler Plumbing, Pella Windows, 200 Amp Service, All Applicable Tax and Much More!!