

# Model #4

28x54 Ranch 1,530 sq. ft.

# Design Homes, Inc.

Missouri Valley, IA  
(#9794 -1-6)



<b>Base Price:</b>	<b>\$123,094.00</b>
<b>This Home Displays The Following Options:</b>	
6/12 Roof Slope	2,646.00
Double Gable	2,358.00
Medium Gable	1,456.00
2-1' Bump-out Rooms	1,718.00
Dbl. 6" Clapboard Vinyl Siding	2,403.00
Split-shake Siding Accents	905.00
Peachtree Windows	4,613.00
Shutters	378.00
Carpet Upgrade LR, BR #1 (EDL II)	1,349.00
Carpet Upgrade BR2 & 3 (Winsford)	401.00
Vaulted Ceilings R-50 (LR, Din & Kit.)	1,444.00
6 Panel Oak Doors (x7)	1,505.00
Paddle Fan Light (LR)	204.00
Laundry Area	428.00
Extra 3/4 Bath	2,450.00
Double Sink Vanity	725.00
Shower Door (x2)	570.00
Vanity Drawer Bases (x2)	264.00
Recessed Medicine Cabinet (x2)	130.00
Wire For Electric Range	100.00
Seneca Ridge Oak Cabinets (disc.)	2,400.00
5' of Extra Wall Cabinets	615.00
6' of Extra Base Cabinets	966.00
Custom Cabinets	281.00
Ceramic Tile Backsplash	350.00
Crown Molding (38')	608.00
Mullion Glass Door	128.00
Hi Macs Kitchen Countertop	5,301.00
Pull-out Kit. Faucet (K15160-CP)	195.00
Rubbed Bronze Package	920.00
4 Suntubes	2,240.00
Painted Exterior Front Door	136.00
Deadbolt (x2)	90.00
6' Peachtree Fr. Swing Patio Dr. (Din)	1,306.00

**Total With Options Shown: \$164,677.00**

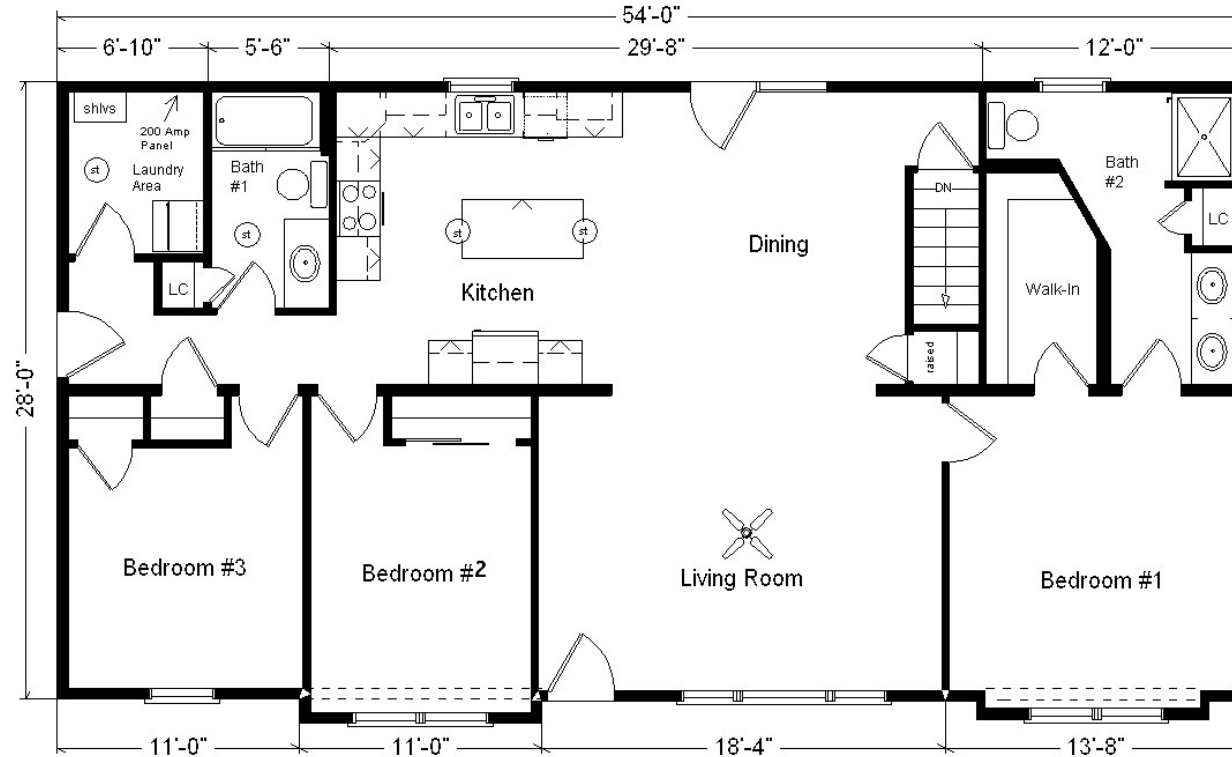

*Drapes & appliances shown are optional and not included in Total price.*

**Buy Display Model For: \$135,470.00!**  
(Discounted 29,207 !)

Sept 2020

**Color Information**  
 S. Wicker Siding, Nat. Clay Shake Siding Accents, White Trim, Weatherwood Shingles, Green Shutters, White Baths, Cedar Carpet in LR & BR1, Timberline Carpet in BR2 & 3, 91057 Vinyls, S118 Cream Sink, Nutmeg Oak Trim & Doors, Peachtree Dbl-hung White Windows, Venetian Sand Countertop w/Rollover Edge

MN #BC146710

**Price Includes:** 100 Mile Delivery, Crane Work, All Blueprints, R55 Ceilings, R21 Exterior Walls, 2x10 Floor Joists, Kohler Plumbing, Pella Windows, 200 Amp Service, All Applicable Tax and Much More!!